

Working in Occupied Healthcare Facilities - It's Different

Our Mantra - Do No Harm



CASEY O'CALLAGHAN

SUPERINTENDENT



EXPERIENCE: 16 YEARS



HEALTHCARE REFERENCES

[Kathy Robinson](#)

Ascension Medical Group
(630) 856-2353

[Kevin Loss](#)

Ascension Saint Alexius
(224) 299-4871

Casey O'Callaghan is a superintendent with extensive experience in the construction industry. He is responsible for coordinating all construction activities and ensuring that subcontractors perform to the specifications of the project. Casey's role also includes overseeing on-site personnel, maintaining project schedules, and ensuring project safety and quality control.

With over 16 years of experience, Casey has successfully supervised a range of renovation and new construction projects in various markets, including healthcare, retail, industrial, institutional, and commercial. He is OSHA 10 Hour certified, indicating his knowledge of safety standards and regulations set by the Occupational Safety and Health Administration. Casey has received his Construction Site Supervision Certification from Purdue University.

Casey O'Callaghan served as Superintendent on the following projects:

Ascension Saint Alexius - Hoffman Estates, IL

SPD Renovation Project: Renovation of an unused prep and storage location to create Staff Locker rooms and new lounges, as well as expanding the Hospital's nurse station and staff office areas. This also included the renovation of the Sterile Department by relocating the cart washer machine and creating a new sterile storage area for surgical instruments and provided a new RO water system and removed old equipment.

Additional Construction Experience: A Major Acute Care Facility in the Chicago Metro Area

A major Acute Care facility in Chicago Metro Area was selected by IDPH for a CMS inspection and received a list of violations. Michuda worked with the construction manager, to develop a plan of correction and corrected over 1200 fire dampers and numerous other code violations over (30) months while working within occupied areas of the hospital. One unique challenge was the fireproof rating of the five (5) stairwells, which were found to be correct after destructive testing, saving the client over \$5M in costs. Redirecting ventilation from the floor above to the floor below was another long-term corrective action of the project, eliminating the need and maintenance of over 200 dampers.

Advocate Lutheran General Hospital - Park Ridge, IL

ED Annex & Adult Behavioral Health Renovation Project: Included the renovation of the ED Annex and Adult Behavioral Health Unit including upgrades to decrease ligature points and risks associated with Behavioral Health patients as well as finish upgrades.

Advocate Chris Hospital & Medical Center - Oak Lawn, IL

PCICU Project: Renovation of a (16) bed PCICU within an Acute Care hospital.

BRYAN PEPPER

SUPERINTENDENT



EXPERIENCE: 17 YEARS



HEALTHCARE REFERENCES

[Kathy Robinson](#)

Ascension Medical Group
(630) 856-2353

[Kevin Loss](#)

Ascension Saint Alexius
(224) 299-4871

Bryan Pepper is a superintendent with extensive experience in the construction industry. He is responsible for coordinating all construction activities and ensuring that subcontractors perform to the specifications of the project. Bryan's role also includes overseeing on-site personnel, maintaining project schedules, and ensuring project safety and quality control.

With over 17 years of experience, Bryan has successfully supervised a range of renovation and new construction projects in various markets, including healthcare, retail, industrial, institutional, and commercial. He is OSHA 30 Hour certified, indicating his knowledge of safety standards and regulations set by the Occupational Safety and Health Administration. Bryan has received his Construction Site Supervision Certification from Purdue University.

Bryan Pepper served as Superintendent on the following projects:

Ascension Saint Alexius - Hoffman Estates, IL

Emergency Department Addition Project: Construction of seven (7) new behavioral health exam pods and ambulance entry points, and a comprehensive renovation of the existing emergency department and observation areas on the first floor. The new behavioral health exam pods and ambulance entry points were designed specifically to address the needs of patients in crisis, while the renovation of the existing emergency department and observation areas aimed to improve overall functionality and patient experience.

Ascension Saint Alexius - Hoffman Estates, IL

Kitchen Renovation Project: Relocation of existing kitchen equipment and sawcutting the floor to excavate spoils and pour new concrete, followed by installation of new tile flooring. The project was completed while the kitchen was still in use, and the Team coordinated with the staff to determine when and where work could be done. To minimize disruption, a trailer was provided outside for kitchen staff to work out of while the floor was being redone.

Additional Construction Experience: Advocate South Suburban - Hazel Crest, IL

Cath Lab Addition Project: The construction of the new suite included three (3) holding bays, common nursing station for both laboratories and state-of-the-art equipment.





Advocate South Suburban - Hazel Crest, IL

3rd Floor Security Lobby Project: Upgrade Security Lobby for Pediatrics.



What is occupied space in a healthcare facility?

Acute or offsite facility where the contractor operations could have a potential adverse impact on patient outcomes for:

-  **Patients**
-  **Staff**
-  **Visitors**
-  **Facilities**

Just because you are a seasoned healthcare contractor does not necessarily mean that those skillsets translate into working within an occupied healthcare facility



Extra steps

Working within occupied healthcare spaces

- PCRA
- ICRA
- ILSM

All factor into driving cost, schedule, and potentially design

Additional coordination is needed throughout the project, additional risks

We serve multiple customers at the same time

- PD&C Department
- Nursing Staff - Department Heads
- Facilities
- End Users

Constant Coordination

- Advise clinicians of upcoming activities that may adversely affect patient outcomes and care-
Nursing Staff
- Coordination with facilities regarding permitting, shutdowns, outages
- Interim AHJ inspections



Phasing

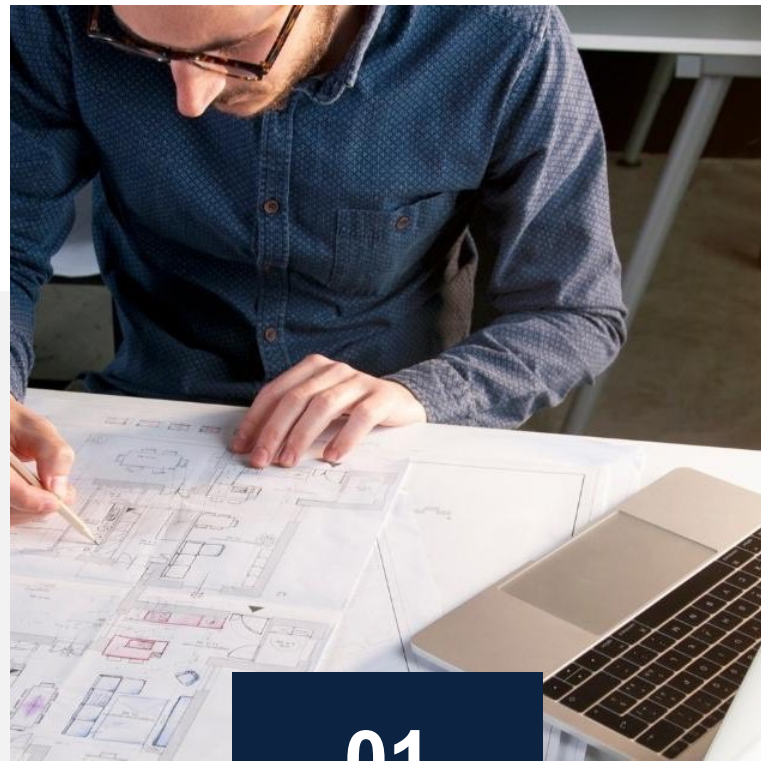

01

Why do Owners ask Architects to devise the phasing plan without contractor input? It does not make sense.



02

Construction Manager and trade partners should be involved during Programming phase to provide input on phasing, not after the drawings are completed.



03

Phasing can be the primary driver in overall schedule and cost.

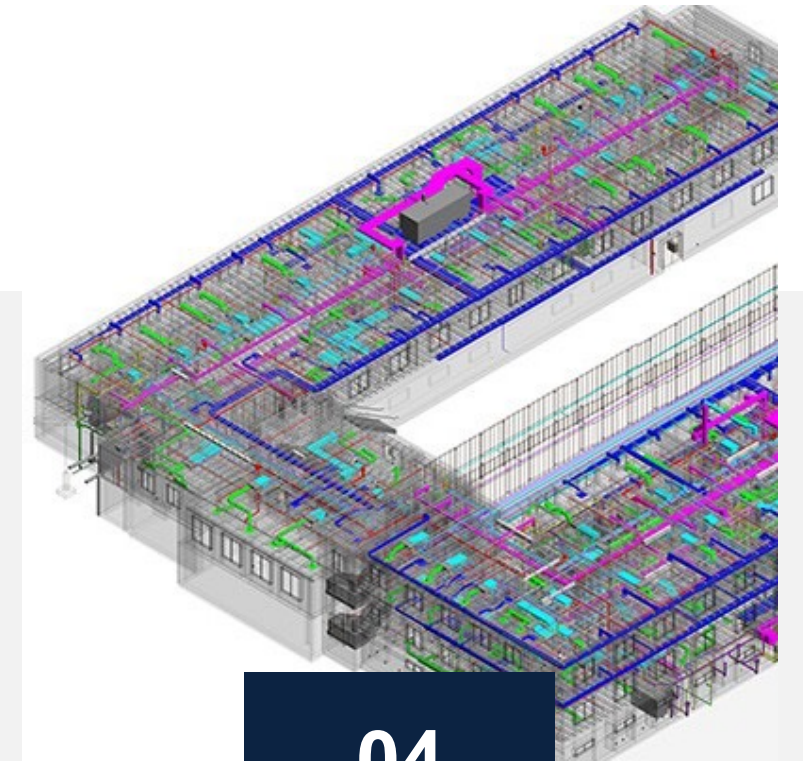

04

Phasing is usually driven by above ceiling and below floor MEP systems, not Architectural layouts.

Last Planner System

Collaboration is key

Pull Planning

A collaborative way of including the trade partner superintendents and foremen in the planning and scheduling process that gains acceptance and buy in, rather than dictating a schedule to trade partners without their input



Many times the Big Room is not available

RefineMySite is an easy way to conduct Pull Planning with virtual post-it-notes when a Big Room is not available

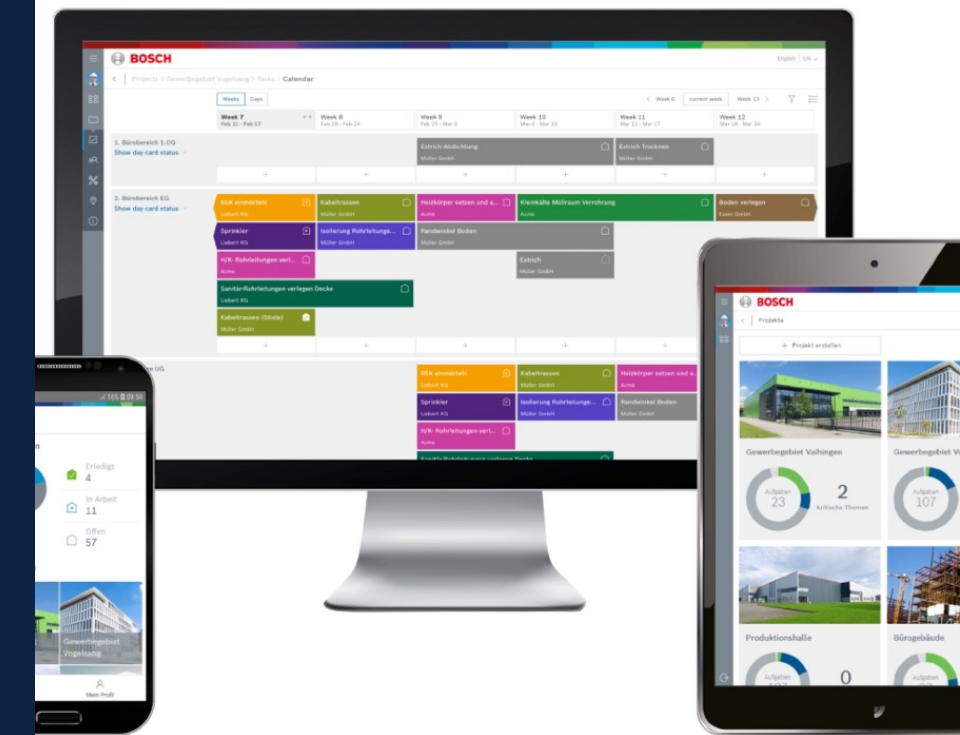

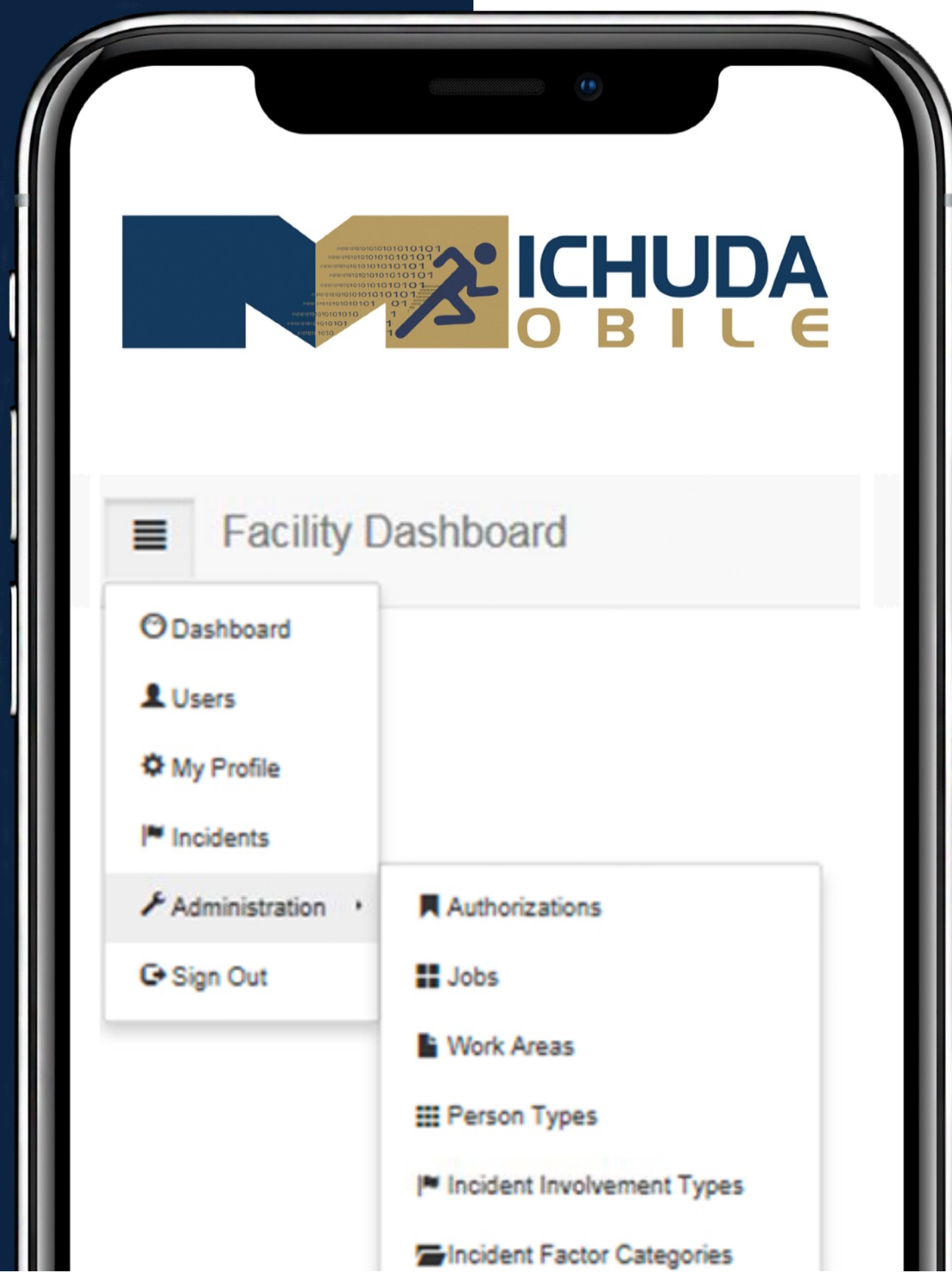

Our technology

Michuda Mobile

- Credentialing
- Authorizations
- Who, What, Where
- Safety Incident Management and Just Cause Outcome
- Good Catches

Thank You

Q & A

www.michuda.com

Tradition Powering Innovation

Family

Balance

ESTABLISHED 1919

Leadership

Safety

Quality

